

**FOR INFORMATION ONLY:
DO NOT MANUFACTURE PARTS TO THIS DRAWING**

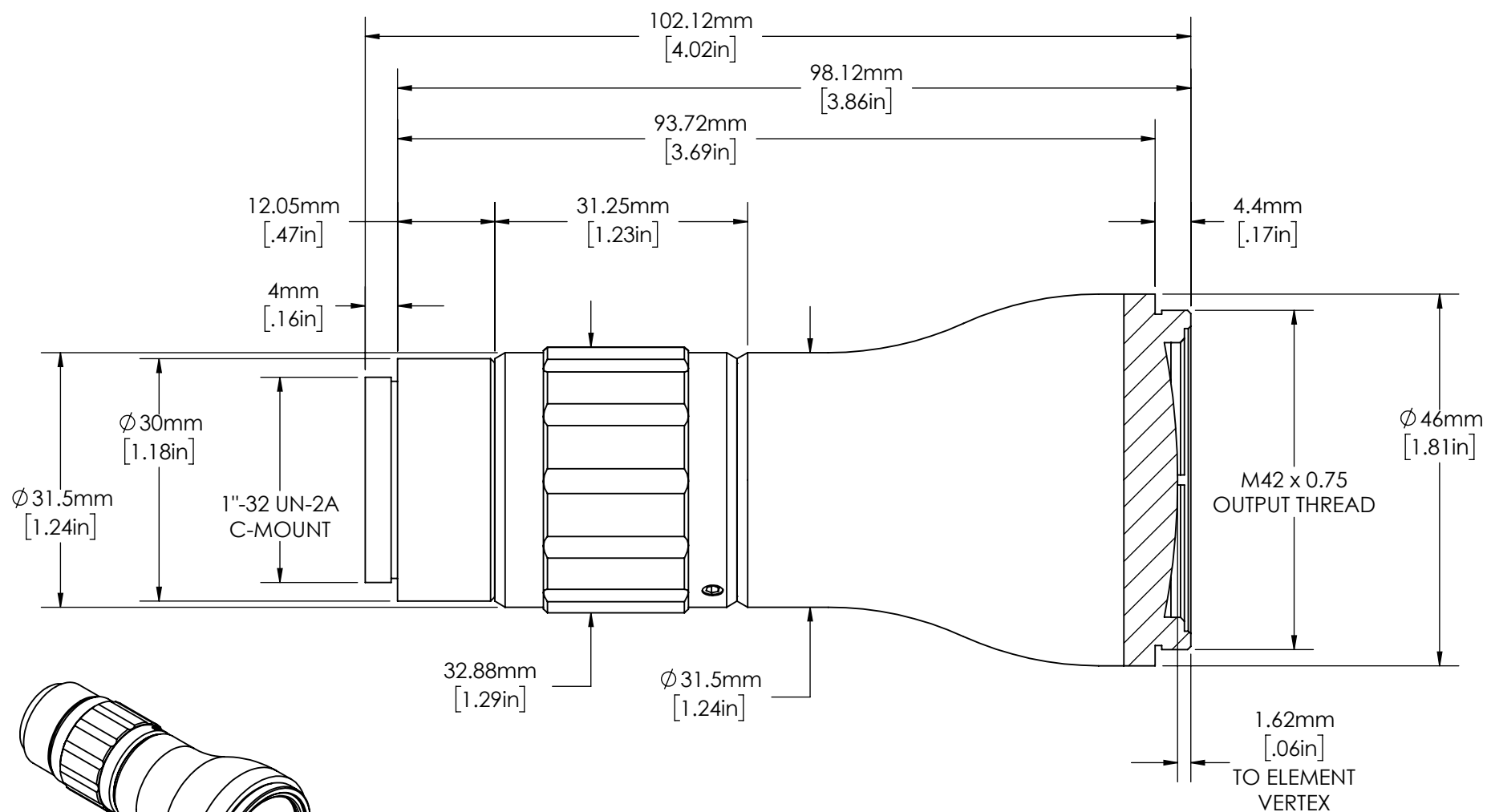

SPECIFICATIONS SUBJECT TO CHANGE WITHOUT NOTICE
DIMENSIONS ARE FOR REFERENCE ONLY
DIMENSIONS ARE IN mm [INCHES]

EXPANSION POWER	10X
DESIGN WAVELENGTH	510 - 555nm
CENTER WAVELENGTH	532 \pm 1nm
ENTRANCE BEAM MAX DIAMETER	3.00mm
INPUT APERTURE DIAMETER	8.00mm

 Edmund Optics			
TITLE	10X, 532nm Draconis™ Nd:YAG Laser Line Beam Expander		
DWG NO	59127	REV	02