

NOTES:

1. CONSTRUCTION: MOUNTED IN BLACK ANODIZED RING
2. COATING (APPLY ACROSS COATING APERTURE)

DURABILITY: MIL-C-48497A
 PERFORMANCE SPECIFICATIONS:
 CWL: 355nm, 532nm & 1064nm
 FWHM: 10 @ 355nm; 25 @ 532nm; 50 @ 1064nm

R (ABS) > 99.5% @ 355nm & 532nm & 1064nm
 T (ABS) < 0.001% @ 355nm & 532nm & 1064nm
 T (AVG) ≥ 80% FROM 325 - 345nm & 370 - 400nm
 T (AVG) ≥ 90% FROM 400 - 510nm & 550 - 1025nm & 1100 - 1200nm

3. SURFACE QUALITY: 60-40
4. TRANSMITTED WAVEFRONT DISTORTION RMS @632.8nm: 1λ
5. ROHS COMPLIANT

6. ARROW ON PART POINTS TOWARDS COATED SURFACE

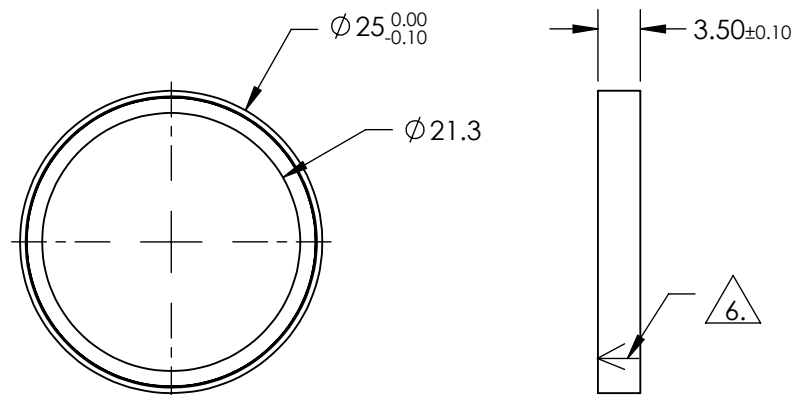
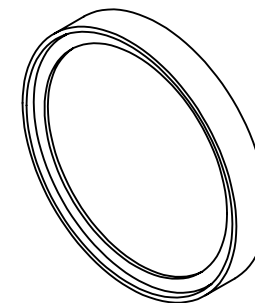

SPECIFICATIONS SUBJECT TO CHANGE WITHOUT NOTICE
 DIMENSIONS ARE FOR REFERENCE ONLY

**FOR INFORMATION ONLY:
 DO NOT MANUFACTURE
 PARTS TO THIS DRAWING**

Edmund Optics®

THIRD ANGLE PROJECTION		TITLE	OD6, Ø25mm, 355 532 & 1064nm, MULTI-NOTCH FILTER	
		DWG NO	87022	SHEET 1 OF 1