

NOTES:

1. SUBSTRATE MATERIAL:  
BOROFLOAT®
2. COATING (APPLY ACROSS CLEAR APERTURE)  
  
S1: UV ENHANCED ALIUMINUM  
R(avg) >89% @ 250 - 450nm  
R(avg) >85% @ 250 - 700nm  
DENSITY LIMIT: 0.5 J/cm² @ 355nm, 10ns  
S2: NONE

3. POWER, IRREGULARITY, SURFACE QUALITY, AND COATING SPECIFICATIONS APPLY ACROSS CLEAR APERTURE

4. FINE GROUND SURFACE

5. ROHS COMPLIANT

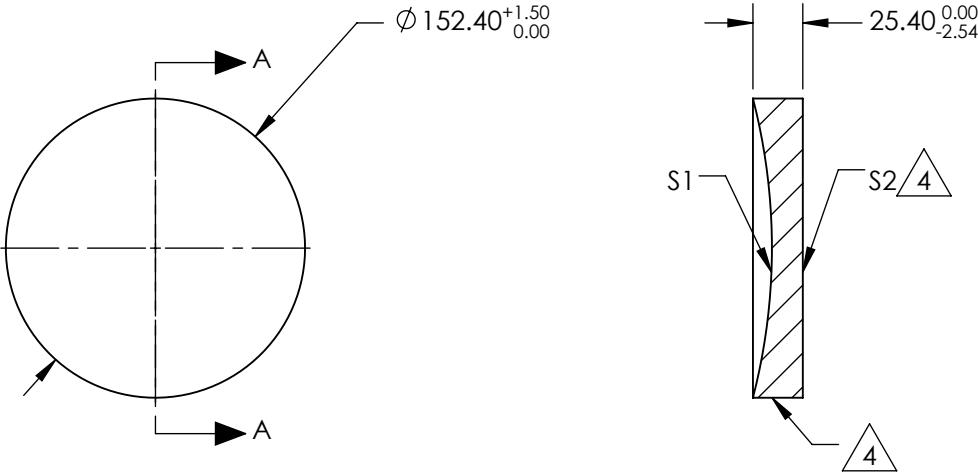

SECTION A-A

**FOR INFORMATION ONLY:  
DO NOT MANUFACTURE  
PARTS TO THIS DRAWING**

SPECIFICATIONS SUBJECT TO CHANGE WITHOUT NOTICE  
DIMENSIONS ARE FOR REFERENCE ONLY

REV. A	S1	S2
SHAPE	CONCAVE	PLANO
EFFECTIVE FOCAL LENGTH	152.4mm	N/A
FOCAL LENGTH TOLERANCE	±2%	N/A
APERTURE	f/1	N/A
SURFACE QUALITY	60-40	60-40
SURFACE FLATNESS	λ/4	λ/4
BEVEL	PROTECTIVE AS NEEDED	PROTECTIVE AS NEEDED

THIRD ANGLE PROJECTION		TITLE	Ø6in, 6in FL UV ENHANCED ALIUMINUM, SPHERICAL MIRROR	
ALL DIMS IN	mm	DWG NO	43561	SHEET 1 OF 1

Edmund Optics®