

NOTES:

1. SUBSTRATE MATERIAL:
FUSED SILICA
2. CENTERING TOLERANCE (AT 587.6nm):
PLANO AXIS WEDGE: < 3 ARCMIN
POWER ASIX WEDGE: < 4.5 ARCMIN
AXIAL TWIST: < 3 ARCMIN
3. COATING (APPLY ACROSS CLEAR APERTURE)

S1 & S2: R(AVG) ≤0.4% FROM 425-675nm @ 0° AOI
4. FINE GROUND SURFACE
5. POWER, IRREGULARITY, AND SURFACE QUALITY
SPECIFICAIONS APPLY ACROSS CLEAR APERTURE
6. ROHS COMPLIANT

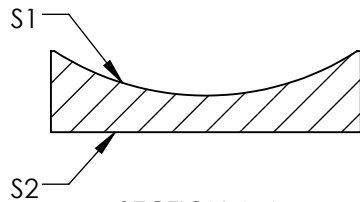
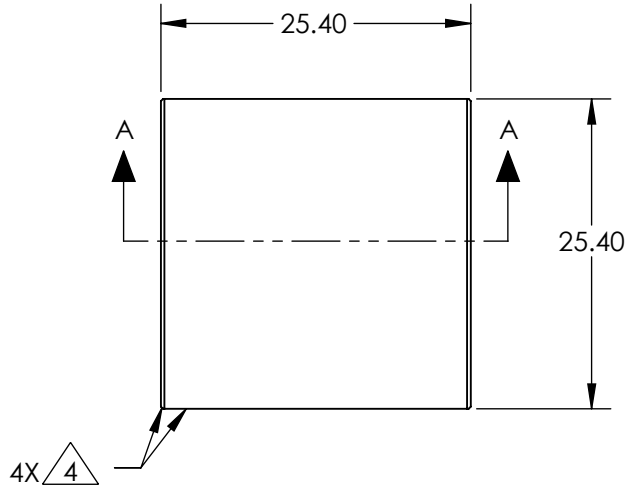

SECTION A-A

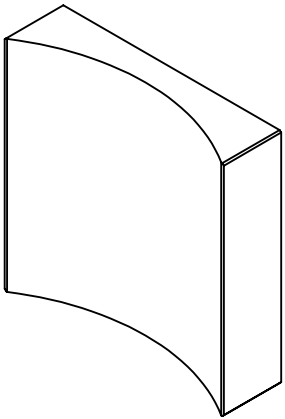

**FOR INFORMATION ONLY:
DO NOT MANUFACTURE
PARTS TO THIS DRAWING**

SPECIFICATIONS SUBJECT TO CHANGE WITHOUT NOTICE
DIMENSIONS ARE FOR REFERENCE ONLY

Edmund Optics®

REV. A	S1	S2				
SHAPE	CONCAVE	PLANO				
SURFACE QUALITY	40 - 20	40 - 20				
CLEAR APERTURE	22.86 x 22.86	22.86 x 22.86				
BEVEL	PROTECTED AS NEEDED	PROTECTED AS NEEDED				

THIRD ANGLE PROJECTION		TITLE	LENS CYL SHAPING 25.4mm SQ x -50mm VIS 0		
		DWG NO	36104	SHEET 1 OF 1	

ALL DIMS IN	mm				
-------------	----	--	--	--	--