

NOTES:

- 1. SUBSTRATE:
SILICON (Si)
- 2. SURFACE S2 TO BE PARALLEL TO S1 WITHIN <3 ARCMIN
- 3. COATING (APPLY ACROSS CLEAR APERTURE)

S1&S2: BBAR(1650-3000nm)
Ravg <1% @ 1650 - 3000nm, Rabs <2% @ 1650 - 3000nm
- 4. FINE GRIND SURFACE
- 5. ROHS COMPLIANT

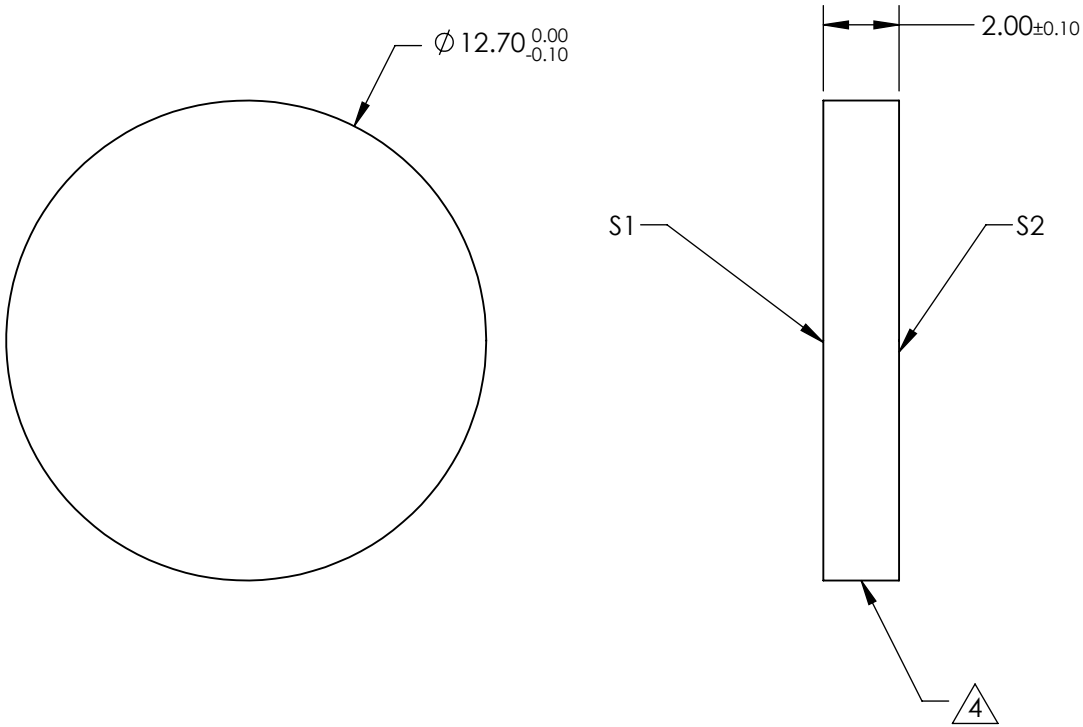
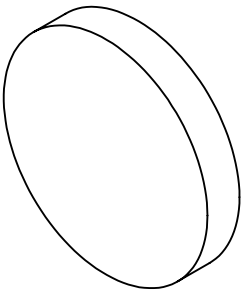

**FOR INFORMATION ONLY:
DO NOT MANUFACTURE
PARTS TO THIS DRAWING**

SPECIFICATIONS SUBJECT TO CHANGE WITHOUT NOTICE
DIMENSIONS ARE FOR REFERENCE ONLY

	S1	S2
SHAPE	PLANO	PLANO
CLEAR APERTURE	Ø 11.43	Ø 11.43
SURFACE QUALITY	60-40	60-40
SURFACE FLATNESS	1λ	1λ
BEVEL	PROTECTED AS NEEDED	PROTECTED AS NEEDED

 Edmund Optics®			
THIRD ANGLE PROJECTION 		TITLE	12.7mm Dia. x 2mm Thickness 1.65-3µm Coated Silicon Window
ALL DIMS IN	mm	DWG NO	20027
			SHEET 1 OF 1