

NOTES:

- 1. SUBSTRATE:  
SILICON (Si)
- 2. SURFACE S2 TO BE PARALLEL TO S1 WITHIN <3 ARCMIN
- 3. COATING (APPLY ACROSS CLEAR APERTURE)  
  
S1&S2: BBAR(1650-3000nm)  
Ravg <1% @ 1650 - 3000nm, Rabs <2% @ 1650 - 3000nm
- 4. FINE GRIND SURFACE
- 5. ROHS COMPLIANT

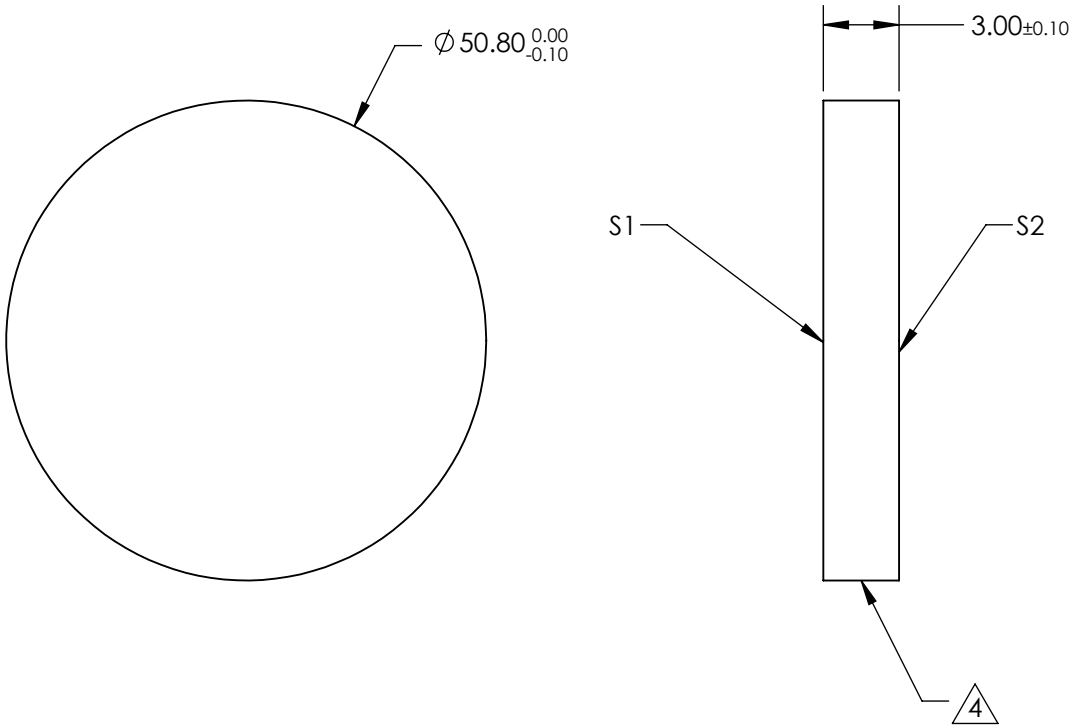
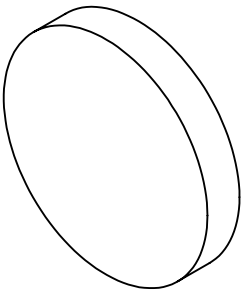

**FOR INFORMATION ONLY:  
DO NOT MANUFACTURE  
PARTS TO THIS DRAWING**

SPECIFICATIONS SUBJECT TO CHANGE WITHOUT NOTICE  
DIMENSIONS ARE FOR REFERENCE ONLY

	S1	S2
SHAPE	PLANO	PLANO
CLEAR APERTURE	Ø 45.72	Ø 45.72
SURFACE QUALITY	60-40	60-40
SURFACE FLATNESS	1λ	1λ
BEVEL	PROTECTED AS NEEDED	PROTECTED AS NEEDED

THIRD ANGLE  
PROJECTION

ALL DIMS IN

mm

 Edmund Optics®

TITLE

50.8mm Dia. x 3mm Thickness 1.65-3µm  
Coated Silicon Window

DWG NO

20033

SHEET  
1 OF 1