

NOTES:

- 1. SUBSTRATE:
Calcium Fluoride (CaF2) Vacuum UV Grade
- 2. SURFACE S2 TO BE PARALLEL WITH S1 TO <1
- 3. COATING (APPLY ACROSS CLEAR APERTURE)
S1 & S2: BBAR (2000-5000nm)
- 4. FINE GRIND SURFACE

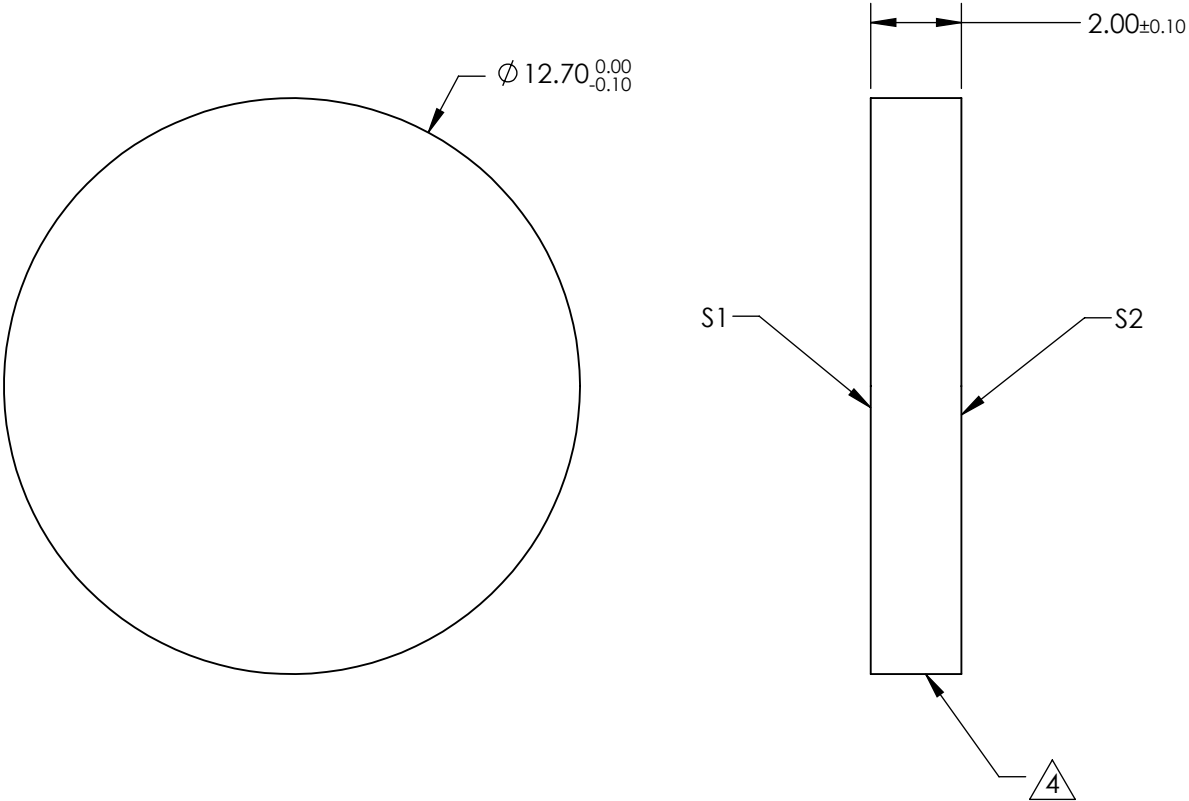
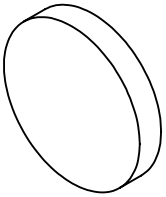

**FOR INFORMATION ONLY:
DO NOT MANUFACTURE
PARTS TO THIS DRAWING**

SPECIFICATIONS SUBJECT TO CHANGE WITHOUT NOTICE
DIMENSIONS ARE FOR REFERENCE ONLY

	S1	S2
SHAPE	PLANO	PLANO
SURFACE QUALITY	40-20	40-20
CLEAR APERTURE	Ø 11.43	Ø 11.43
BEVEL	PROTECTED AS NEEDED	PROTECTED AS NEEDED

THIRD ANGLE PROJECTION				Edmund Optics®	
ALL DIMS IN		mm	TITLE	12.7mm Dia. x 2mm Thick, BBAR (2000-5000nm) Coated Calcium Fluoride Window	
DWG NO		23512			SHEET 6 OF 28