

NOTES:

- 1. SUBSTRATE:
Barium Fluoride (BaF2)
- 2. SURFACE S2 TO BE PARALLEL WITH S1 TO
- 3. COATING (APPLY ACROSS CLEAR APERTURE)
S1 & S2: BBAR (2000-5000nm)
- 4. FINE GRIND SURFACE

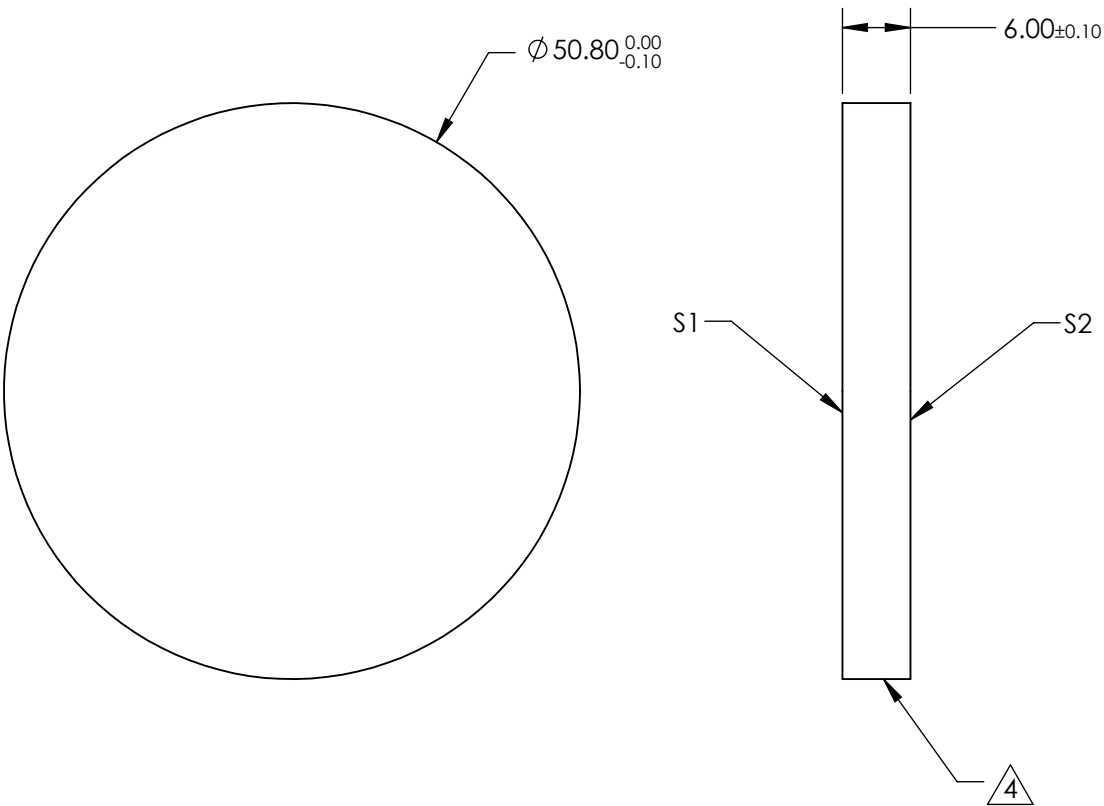
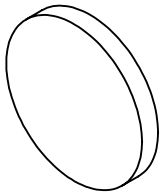

**FOR INFORMATION ONLY:
DO NOT MANUFACTURE
PARTS TO THIS DRAWING**

SPECIFICATIONS SUBJECT TO CHANGE WITHOUT NOTICE
DIMENSIONS ARE FOR REFERENCE ONLY

	S1	S2
SHAPE	PLANO	PLANO
SURFACE QUALITY	60-40	60-40
CLEAR APERTURE	Ø 43.18	Ø 43.18
BEVEL	PROTECTED AS NEEDED	PROTECTED AS NEEDED

THIRD ANGLE PROJECTION		Edmund Optics®	
ALL DIMS IN		TITLE	50.8mm Dia., 6mm Thick, 30' Wedge, BBAR (2000-5000nm) Coated, Barium Fluoride (BaF2) Wedged Window
mm		DWG NO	23720
			SHEET 28 OF 28