

1. SUBSTRATE:
Fused Silica (or equivalent)
2. CENTERING TOLERANCE (AT 587.6nm): <1 ARCMIN
3. COATING (APPLY ACROSS CLEAR APERTURE)

S1&S2: NONE
4. FINE GRIND SURFACE (ADD INK NOTE AS NEEDED)
5. FOCAL LENGTH (EFL): 50mm
BACK FOCAL LENGTH (BFL): 45.02mm
6. ROHS COMPLIANT
7. PROTECTIVE BEVEL AS NEEDED
8. POWER, IRREGULARITY, AND SURFACE QUALITY
SPECIFICATIONS APPLY ACROSS CLEAR APERTURE
9. DESIGN WAVELENGTH: 587.6nm

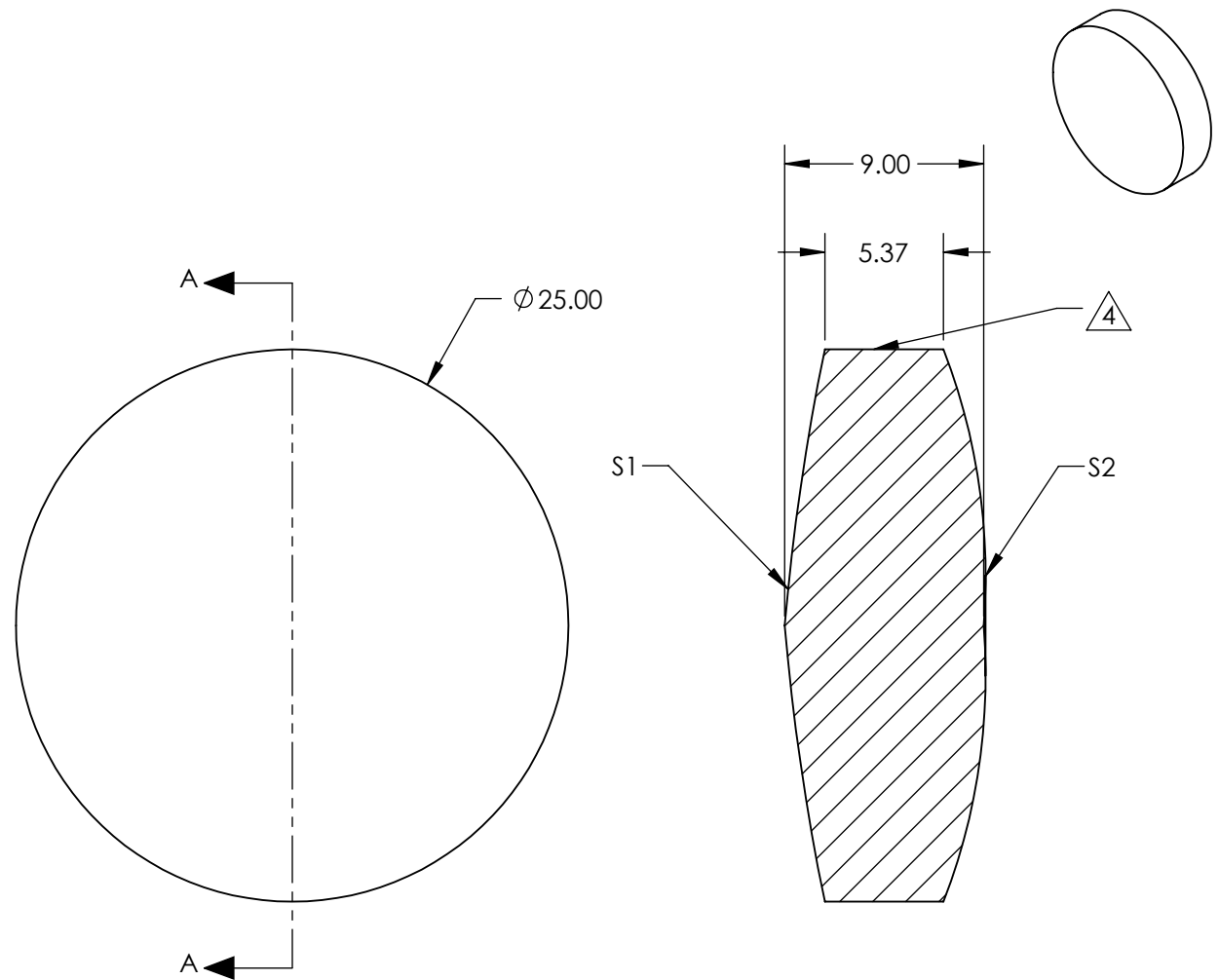

**FOR INFORMATION ONLY:
DO NOT MANUFACTURE
PARTS TO THIS DRAWING**

	S1	S2
SHAPE	PLANO	PLANO
RADIUS	106.90	28.41
SURFACE QUALITY	10-5	10-5
CLEAR APERTURE	Ø 22.5	Ø 22.5
BEVEL	PROTECTED AS NEEDED	PROTECTED AS NEEDED



LENS DCX BF 25 X 50 UNCTD TS

22570

SHEET
6 OF 8