

[See all 18 Products in Family](#)

Standard 1.5X Magnification, InfiniTube

See More by [Infinity Photo-Optical Company](#)



Standard (with no In-Line Attachment), InfiniTube, #56-125



Stock #65-608 [CONTACT US](#)

⊖ 1 ⊕ €1.190⁰⁰

ADD TO CART

Volume Pricing

Qty 1+	€1.190,00 each
Need More?	Request Quote

ⓘ Prices shown are exclusive of VAT/local taxes

Product Downloads

General

InfiniTube™ Standard 1.5X **Model Number:**
Fixed Magnification Lens **Type:**

Optical Properties

Primary Magnification PMAG:

Objective Required

Threading & Mounting

Mount:

C-Mount

Regulatory Compliance

RoHS 2015:

Compliant

Reach 224:

Compliant

Certificate of Conformance:

[View](#)

Product Details

- Direct to Video C-Mount for 2/3" and Smaller Sensor Cameras ([InfiniTube™ FM Series](#) for 1/2")
- [Mitutoyo](#) and [Achromid™](#) Objectives Sold Separately
- Internal Focusing
- See Description Tab for Required Components

This in-line assembly unit is used to mount [Mitutoyo](#) or [Achromid™](#) long working-distance objectives to C-mount cameras, yielding magnifications not possible with ordinary video lenses, such as 50X magnification. The InfiniTube™ system can be configured in a variety of fashions. It can be utilized alone (InfiniTube™ Standard [#56-125](#)) for applications where illumination is provided from another source such as a backlight or directional illumination.

The first in-line attachment ([#56-126](#)) has been designed for high performance with objectives having a magnification of 10X or below and is not suggested for use with higher magnification objectives. The second in-line unit ([#56-191](#)) has been designed to work with increased efficiency when used with magnifications of 10X or higher, but can be utilized with all magnifications. An InfiniTube™ In-line Assembly ([#54-590](#)) is also offered, comprised of the InfiniTube™ Standard and the higher magnification in-line attachment. This Assembly can be used with all magnifications. A filter holder, which attaches to the InfiniTube™ itself, can be added to the systems to introduce 25mm diameter filters. These lenses are commonly used in microscopy and wafer inspection.

By utilizing an in-path beamsplitter and side-port illumination tube with collimating optics, the In-Line Assembly ([#54-590](#)) provides incident illumination parallel to the optical axis (coaxial). Coaxial illumination requires an optional [Fiber Optic Illuminator](#) and a 1/4" diameter [Fiber Optic Light Guide](#).

A version of the InfiniTube™ is specifically designed only for Zeiss ICS-corrected objectives ([#58-538](#), 160mm tube lens design). Shorter than the Standard model, this model has color-compatible correction for use exclusively with Zeiss ICS objectives. The RMS adapter ([#53-786](#)) is required to connect [#58-538](#) to the Zeiss EC Plan-Neofluar® objectives.

The RMS adapter ([#53-786](#)) is required to connect [#58-538](#) to the Zeiss ICS objectives. Since even the slightest vibration will affect such small fields-of-view seen with the InfiniTube™ we recommend [vibration isolation equipment](#) when using objectives greater than 10X in magnification. We also recommend the use of a focusing mechanism (such as the Rack and Pinion Movement mount [#54-794](#)) when using the lens alone.

Mounting clamp ([#57-788](#)) is included with [#54-590](#), [#56-125](#) and [#58-538](#). Note that an objective, objective adapter, light guide, and illuminator are not included.

Technical Information

InfiniTube™ Filter Holder

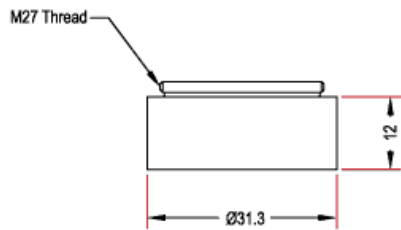

Units: mm

InfiniTube™ Standard

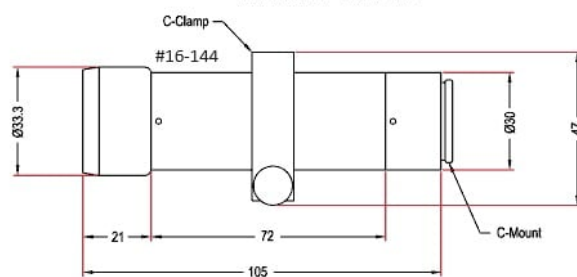

Units: mm

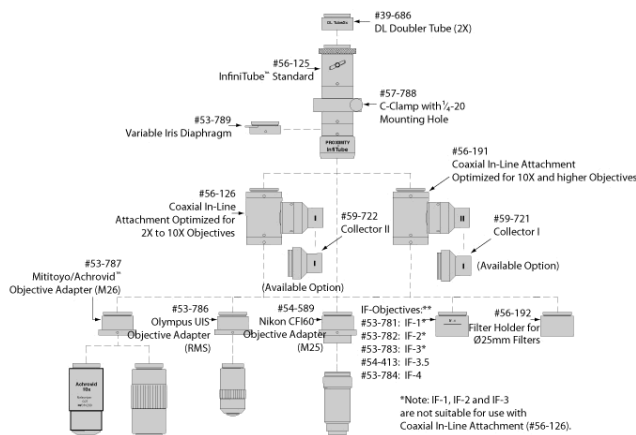

InfiniTube™ In-Line Attachment

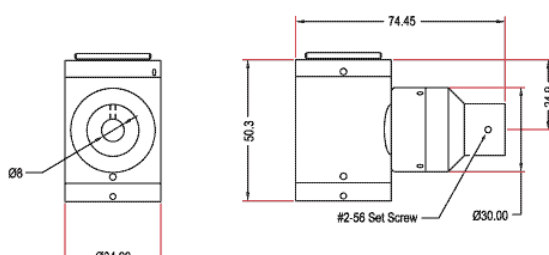

Units: mm

Item	Stock No.
InfiniTube In-Line Assembly Unit	#54-590
Hitachi KP-D20B Camera	#55-837
15.1" LCD Monitor (US Version Only)	#56-522
Y-C Cable (6 ft.)	#39-255
Mitutoyo/Achrovid™ Objective Adapter	#53-787
M-150 Fiber Optic Illuminator	#55-718
Fiber Optic Light Guide (48" L)	#39-367
Fiber Optic Adapter	#38-944
Standard Boom Stand	#54-120
Rack & Pinion Mounting Plate	#54-123

;